

BIBL
CATH
ROFF

Saxon? Cath
transsept area

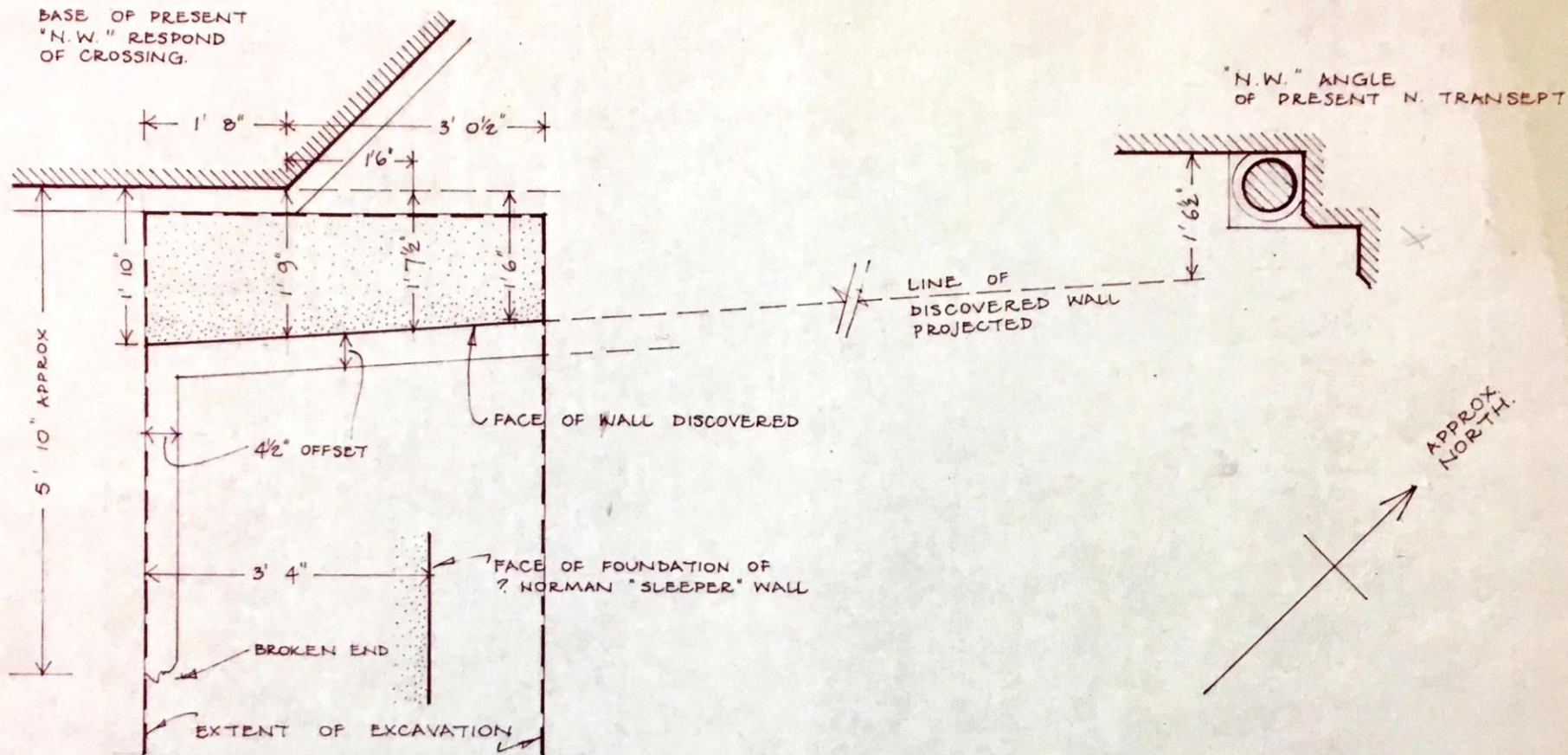

ROCHESTER CATHEDRAL

NOTE OF FOUNDATIONS DISCOVERED ON
RESITING OF POLEY LEDGER AT
NORTH ARCH OF CROSSING.

28 AUGUST 1968.

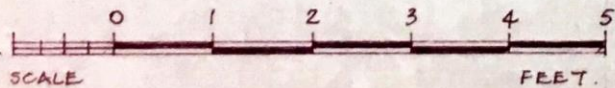

CARDEN GODFREY & MACFADYEN, ARCHITECTS,

120 CHANCERY LANE, LONDON W.C.2.